

## I Applications:

BoxMag-Systems are installed into pipings or drop shafts where powder or fine-grained granulate material are separated from magnetizable particles.

## I Description of functions:

The BoxMag-System's casing is connected to the piping system by flanges thus ensuring a dust-free and unimpaired product flow in the production plant. The material to be conveyed flows through the BoxMag-System and is exposed to the strong magnetic field of the installed magnetic filter rods. Even weak magnetic contaminations in the product are seized, attracted by the filter rods and held tight.

# BoxMag

RFM-SS double layer

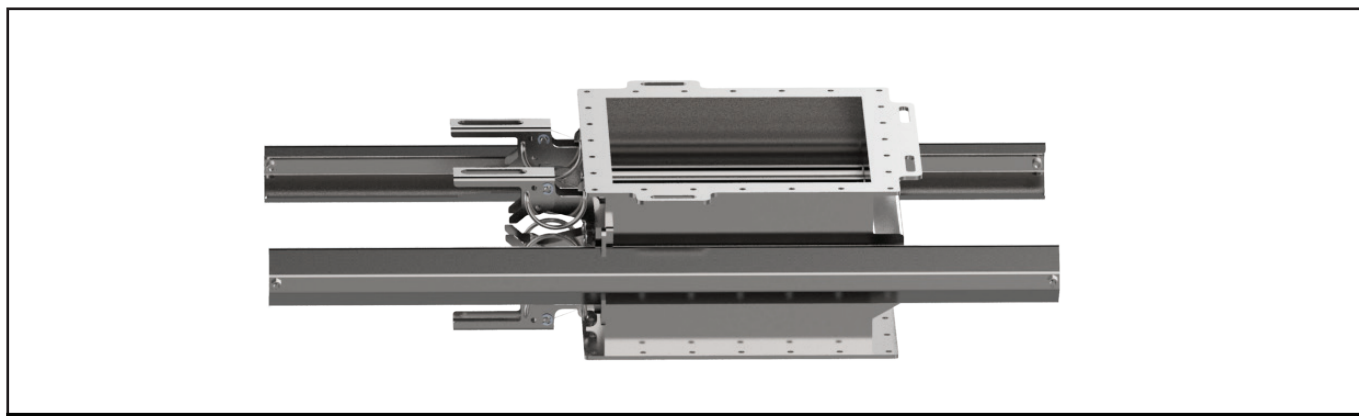

## I Product requirements:

The material to be controlled must be dry, powdery or short-fibred and free-flowing.

## I Housing:

Material: Stainless steel AISI 304

Surface:

Outside blasted with ceramic beads,

Inside smoothed

Inlet and outlet with flanges

(Connection pieces for connecting to the pipes are available upon request)

## I Magnetic material:

High energy neodymium magnets that remove even the finest metal contaminants are used.

Magnetic material:

Energie product max. 342 kJ/m<sup>3</sup>

Coercive force H<sub>cJ</sub> >= 876 kA/m

Remanence B<sub>r</sub> max. 1370mT

Active surface: max. 1000mT

Operating temperature max. 80°C

## I Product description:

The magnetic rods of the BoxMag-separator are arranged in such a way that the product will touch the surface of one filter rod with high probability when flowing through the system. There, it is most likely that even low magnetic particles can be held tight by the strong permanent magnets.

Apart from the optimized arrangement of the magnetic rods it is most important to make the operator's daily work easier during the removal and installation of the magnetic insertion.

Magnetic insertion and EasyClean Unit will be pulled out of the casing at the lateral roller guide rails. They carry the insertions' weight and make sure that they are in the correct working- and cleaning position.

The magnetic plug-in unit is fixed in the casing with spring compressors – easy handling without tools.

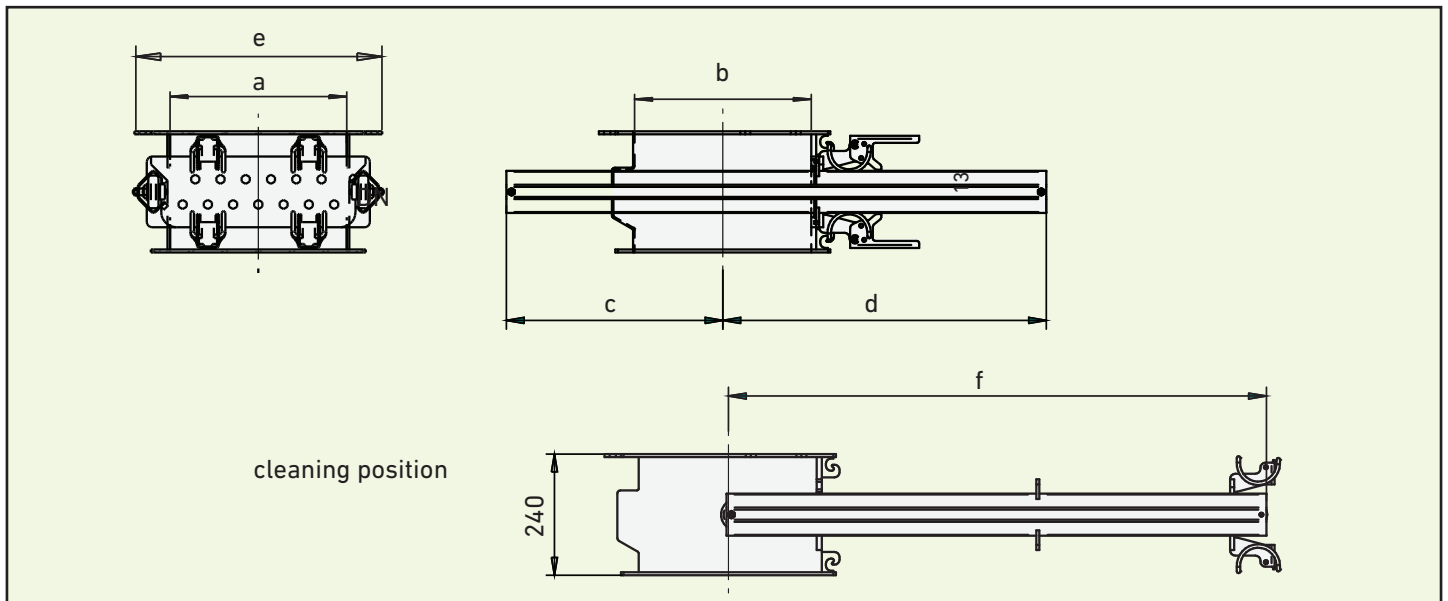

	magnetic bars	a	b	c	d	e	f	kg
<b>Type RFM-SS</b>								
300 x 300	11	300	300	404	566	441	1100	49
350 x 350	13	350	350	429	641	491	1200	57
400 x 400	15	400	400	454	716	541	1300	62
450 x 450	17	450	450	479	791	591	1400	92

## I Cleaning:

The operator opens the fasteners of the spring compressors and pulls the whole insertion out of the casing.

This procedure is simplified by the lateral roller guide rails which carry the weight and stop the EasyClean-stripping unit in the intended end position.

The magnetic insertion will be pulled until the cleaning position is achieved (see fig. on the right). The seized metallic particles remain at the surface of the push-off-sleeves and fall off.

Tools are not necessary!.

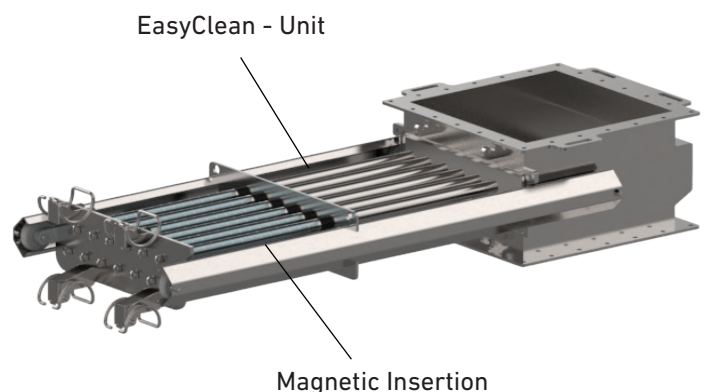

## I ATEX:

BoxMag systems have been tested for freedom from ignition sources in accordance with EU Directive 94/9/EC. All machines are also suitable for use in ATEX Zone 20 (dust) provided the design is adapted accordingly.